

12352

No. _____

Supreme Court of Illinois

Lee

vs.

Newkirk

71641  7

174

David O. Lee
vs
Adams, B. New York

174

176

1857

12352

1857

XX

IN SUPREME COURT,

APRIL TERM, 1857.

DAVID S. LEE, APPELLANT,

VS.

ADAMSON B. NEWKIRK, APPELLEE.

*Appeal from Cook County
Court of Common Pleas.*

THIS was an action of ejectment to recover the following premises, beginning at the N. W. corner of W. $\frac{1}{2}$ N. E. $\frac{1}{4}$ sec. 18 T. 39 N. R. 14 E. and running thence South 160 rods to S. W. corner thereof, thence E. 14 rods 7 links, thence North 50 rods; thence East 6 rods; thence North 110 rods; thence West 20 rods 4 links to place of beginning.

Commenced by the appellant against the appellee, on the 2d day of June, A. D. 1856, in the Cook County Court of Common Pleas. Plea not guilty, and trial by jury at the February Term, 1857.

On the trial the plaintiff offered in evidence a patent from the United States to Truman G. Wright, dated March 16, 1837, of W. $\frac{1}{2}$ N. E. $\frac{1}{4}$ sec. 18 T. 39 N. R. 14 E., containing 80 acres.

Also, deed from the Sheriff of Cook County to Robert Gracie, dated June 19, 1841, setting forth the recovery of a judgment by Robert Gracie against Henry Fake, Truman G. Wright and Anson Weed, in the Municipal Court of the City of Chicago, at a term thereof held on the first Monday of November, 1837, for \$1083.80, besides costs. That an execution issued out of said court upon said judgment, dated May 29, 1838, directed to the High Constable of Chicago for 1097.55 damages, and costs. That on the 16th day of August, 1838, the High Constable levied upon the lands thereafter described as the property of Truman G. Wright; and on the 20th day of February, 1839, an alias execution of that date issued out of said court upon said judgment, directed to the Sheriff of Cook County; and on the 25th day of March, 1839, having advertised the same agreeably to law, sold the W. $\frac{1}{2}$ of N. E. $\frac{1}{4}$ of sec. 18 T. 39, N. R. 14 E. of 3d P. M., to Robert Gracie, and thereupon conveys the same to him.

Also, a deed from Robert Gracie and wife to Charles C. Melletta, dated April 7, 1841, and conveying W. $\frac{1}{2}$ of N. E. $\frac{1}{4}$ sec. 18 T. 39 N. R. 14 E. of 3d P. M. Ack. May 1, 1841. Recorded book 6, page 112.

Also, a warrantee deed from Charles C. Melletta to David S. Lee, (the appellant) dated February 14, 1848, conveying all that part of the W. $\frac{1}{2}$ of the N. E. $\frac{1}{4}$ of sec. 18 T. 39 N. R. 14 E. of 3d P. M., described as follows: beginning at the N. W. corner of said tract and running East along the North boundary line thereof, 30 rods 4 links; thence South 160 rods; thence West along the South boundary line thereof 30 rods 7 links to the S. W. corner of said tract; thence North along the West boundary line thereof 160 rods to the place of beginning; containing 30 acres and a fraction of an acre. Consideration \$350. Ack. February 15, 1848. Recorded

Also, a deed from Charles C. Melletta to Joseph N. Balestier, dated October 26, 1847, and conveying all that part of the W. $\frac{1}{2}$ of the N. E. $\frac{1}{4}$ of sec. 18 T. 39 N. R. 14 E. of 3d P. M., bounded as follows; beginning at a point on the most northerly line thereof, distant 30 rods and 4 links eastwardly from the north westerly corner thereof, and running thence southerly at right angles to said northerly line 160 rods to the most southerly line of said tract of land; thence easterly along said southerly line 30 rods and 8 links; thence northerly at right angles to said southerly line 160 rods to said northerly line, and thence westerly along said northerly line 30 rods and 5 links to the place of beginning.

Also, a deed from Charles C. Melletta to James H. Rees, dated Aug. 30, 1845, and conveying a part of W. $\frac{1}{2}$ of N. E. $\frac{1}{4}$ sec. 18 T. 39 N. R. 14 E., bounded as follows: beginning at the north east corner of said tract, and running thence S. 40 chains, thence W. 5 chains and 5 links, thence N. 40 chains, thence E. 5 chains and 3 links to the place of beginning.

Also, a deed dated 22d day of March, A. D. 1848, from David S. Lee to James Peck and Allen Richmond, conveying part of said tract bounded as follows; beginning at a point on the S. side of said tract 14 rods and 7 links E. from S. W. corner thereof, and running thence E. along the S. side of the said tract 16 rods; thence N. 50 rods; thence due W. 16 rods; thence S. 50 rods to beginning. A deed from Allen Richmond to James Peck, dated 12th Feb. 1849, conveying his undivided half of the tract conveyed by David S. Lee to James Peck and Allen Richmond.

The execution of which were severally admitted.

The plaintiff then put in evidence a plat of said land: *and called*
James H. Rees who testified that the same was
substantially correct.

Scale 4 Chains to an inch.

STREET.

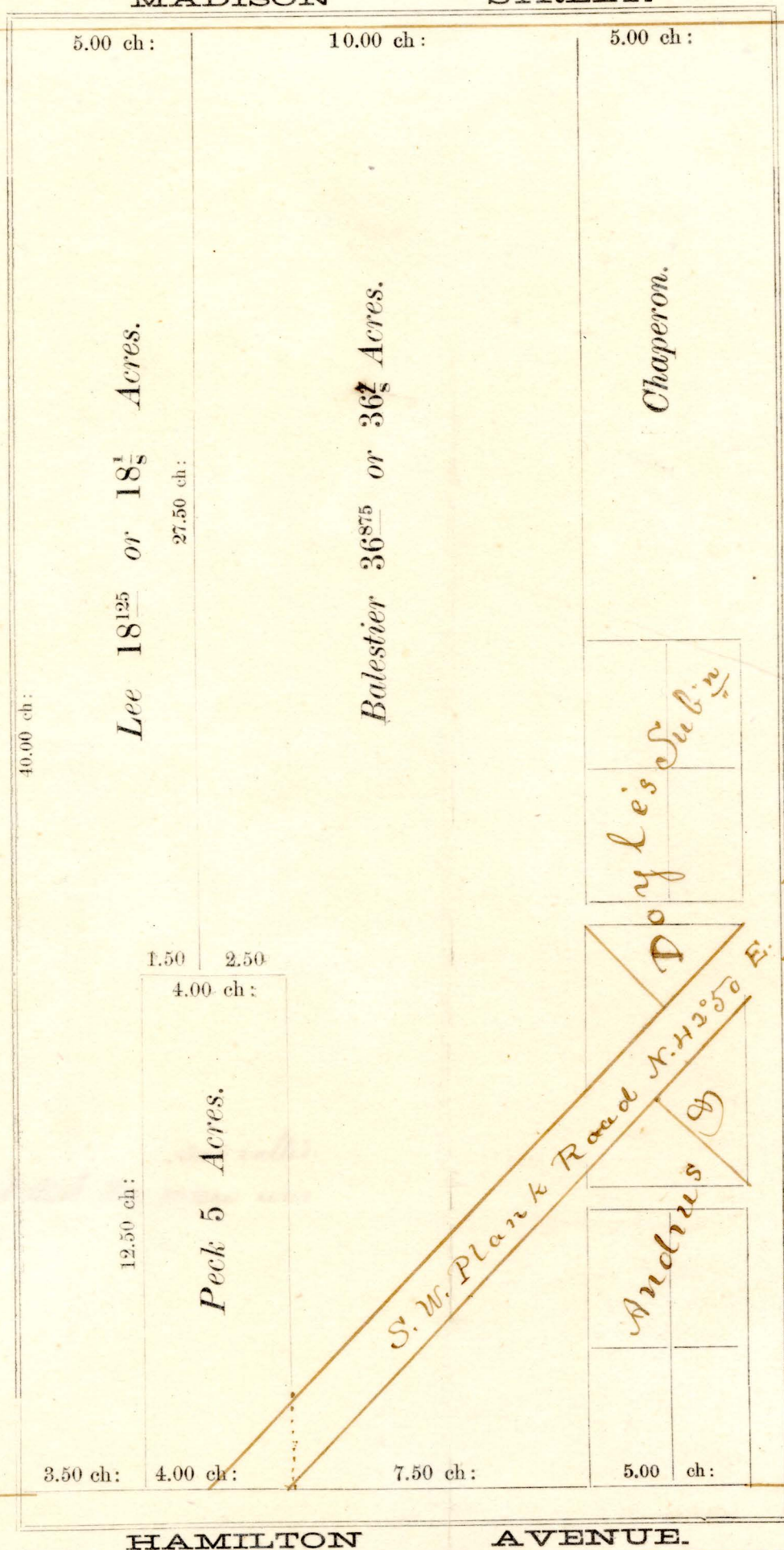

NOTE.—The excess over standard Measure is not noticed in this Plat.

[1235203]

The pff then read in evidence the following tax receipts, and introduced and read in evidence the assessment rolls ^{& collector's accounts} of the City of Chicago, the County of Cook and the town of West Chicago; of which the following are correct extracts.

1848.

TAXES ASSESSED ON LANDS IN CHICAGO—WEST DIVISION.

OWNERS.	DESCRIPTION.	Section	Town.	Range.	Aeres.	Valua- tion.	City Tax.	School Tax.	Special Tax.	
Jos. N. Balestier,	E. $\frac{1}{2}$ of W. $\frac{3}{4}$ of W. $\frac{1}{2}$ N. E. $\frac{1}{4}$	18	39	14	30	2400	6.00	2.40		Pd.
Jas. Peck,	S. E. corner of W. 30 acres of W. $\frac{1}{2}$ of N. E. $\frac{1}{4}$,	"	"	"	5	400	1.00	.40		
David S. Lee,	W. 30 acres except 5 acres S. E. corner assessed to Peck, of W. $\frac{1}{2}$ of N. E. $\frac{1}{4}$	"	"	"	25	1750	4.37	1.75		Pd.

1848.

TAXES ASSESSED ON LANDS IN CHICAGO—WEST DIVISION.

OWNERS.	DESCRIPTION.	Section	Town- ship.	Range	Aeres.	Rate per A.	Valua- tion.	County Tax.	State Tax.	Build'g and int. Taxes.	
J. N. Balestier,	E. $\frac{1}{2}$ of W. $\frac{3}{4}$ of W. $\frac{1}{2}$ of N. E. $\frac{1}{4}$	18	39	14	30	60	1800	7.20	6.30	.36	Pd.
Jas. Peck,	S. E. corner of W. 30 acres of W. $\frac{1}{2}$ of N. E. $\frac{1}{4}$, ..	"	"	"	5	60	300	1.20	1.05	.06	Pd.
D. S. Lee,	W. 30 acres except 5 acres on S. E. corner of W. $\frac{1}{2}$ of N. E. $\frac{1}{4}$	"	"	"	25	55	1375	5.50	4.82	2.75 40	Pd. by D. S. Lee.

Chicago, Nov. 14, 1848.

Received of David S. Lee, Twelve 42-100 dollars, in full for the City and School Taxes assessed for the year 1848, on the following property, viz:

West 25 acres in W. $\frac{1}{2}$ N. E. $\frac{1}{4}$ 18, 39, 14, - - - \$6.12 $\frac{1}{2}$

A. D. TAYLOR, City Collector.

STATE OF ILLINOIS, }
COUNTY OF COOK, } ss.

COLLECTOR'S OFFICE, Chicago,
May 4th, 1849.

Received of David S. Lee, Thirty-Nine 83-100 dollars, in full for County, State, and Special Taxes, assessed for the year 1848, on the following Real Estate situate in said County, viz:

Division.	Sec.	Town N.	Range E.	Acres.	Valuation.	Co. Tax.	State Tax.	Spec. Tax.	Total.
W. $\frac{1}{2}$ N. E. $\frac{1}{4}$,	18	39	14	25	55	5.50	4.82	.40	10.72

I. COOK, BY RANKIN,
Sheriff and Collector of Cook Co.

\$8.93.

Chicago, Nov. 14, 1848.

Received of David S. Lee for Jos. N. Balestier, Eight 93-100 Dollars, in full for the City and School Taxes assessed for the year 1848, on the following property viz:

5 acres in S. E. corner of N. $\frac{1}{2}$ N. E. $\frac{1}{4}$ sec. 6. T. 39 N. R. 14.

5 acres in S. W. corner of W. $\frac{1}{2}$ N. W. $\frac{1}{4}$ sec. 6 T. 39 N. R. 14.

30 acres in middle part of W. $\frac{1}{2}$ N. E. $\frac{1}{4}$ sec. 18 T. 39 N. R. 14.

A. D. TAYLOR, City Collector.

STATE OF ILLINOIS, }
COUNTY OF COOK, } ss.

Chicago, Jan'y 6, 1849.

Received of David S. Lee, for Jos. N. Balestier, Seventeen 52 $\frac{1}{2}$ -100 dollars, in full for County, State and Special Taxes assessed for the year 1848, on the following Real Estate, situate in said County, viz:

Division.	Sec.	Town N.	Range E.	Acres.	Valuation.	Co. Tax.	State Tax.	Spec. Tax.	Total.
W. $\frac{1}{2}$ S. W. $\frac{1}{4}$,	26	39	13	80	3.20	1.28	1.12	39	2.79
W. $\frac{1}{2}$ N. E. $\frac{1}{4}$,	6	39	14	5	.75	.30	.27	2	.59
E. $\frac{1}{2}$ N. W. $\frac{1}{4}$,	6	39	14	5	.37 $\frac{1}{2}$.15	.13 $\frac{1}{2}$	1	29 $\frac{1}{2}$
W. $\frac{1}{2}$ N. E. $\frac{1}{4}$,	18	39	14	30	18.00	7.20	6.30	36	13.86

\$17.53 $\frac{1}{2}$

I. COOK.

1849.

TAXES ASSESSED ON LANDS IN CHICAGO—WEST DIVISION.

Co & State

OWNERS.	DESCRIPTION.	Section	Town-ship.	Range	Acres.	Rate per A.	Valua-tion.	County Tax.	State Tax.	Blind & Insane Tax.	
✓ Jos. N. Balestier,	E. $\frac{1}{2}$ of W. $\frac{3}{4}$ of W. $\frac{1}{2}$ of N. E. $\frac{1}{4}$,-----	18	39	14	30	60	1800	7.20	9.90	.54	Pd.
Jas. Peck and Allen Richmond,	Part of W. $\frac{1}{2}$ W. $\frac{3}{4}$ of W. $\frac{1}{2}$ of N. E. $\frac{1}{4}$ beginning } at S. E. corner, thence W. 4 chains N. 12.50 } chs., E. 4 chs., and S. 12.50 chs. to beginning,	"	"	"	5	60	300	1.20	1.65	.09	
✓ David S. Lee,----	W. $\frac{1}{2}$ of W. $\frac{3}{4}$ of W. $\frac{1}{2}$ of N. E. $\frac{1}{4}$ except 5 acres } assessed to Peck and Richmond,-----	"	"	"	25	50	1250	5.00	6.88	37.75 37.72	Pd.

City

1849.

TAXES ASSESSED ON LANDS IN CHICAGO—WEST DIVISION.

OWNERS.	DESCRIPTION.	Section	Town-ship.	Range	Acres.	Valua-tion.	City Tax.	School Tax.	Special Tax.	
✓ Jos. N. Balestier,	E. $\frac{1}{2}$ of W. $\frac{3}{4}$ of W. $\frac{1}{2}$ N. E. $\frac{1}{4}$,-----	18	39	14	30	2400	6.00	2.40	2.40	Pd.
Jas. Peck, and Allen Richmond,	Part of W. $\frac{1}{2}$ of W. $\frac{3}{4}$ of W. $\frac{1}{2}$ of N. E. $\frac{1}{4}$ begin- } ning at S. E. corner, thence W. 4 chs., N. 12.50 } chs., E. 4 chs., and S. 12.50 chs. to beginning,	"	"	"	5	400	1.00	.40	.40	
✓ David S. Lee,----	W. $\frac{1}{2}$ of W. $\frac{3}{4}$ of W. $\frac{1}{2}$ of N. E. $\frac{1}{4}$ except 5 acres } assessed to Peck and Richmond,-----	"	"	"	25	1700	4.37	1.75	1.75	Pd.

STATE OF ILLINOIS, }
CITY OF CHICAGO. } ss.

COLLECTOR'S OFFICE, Chicago,
February 9th, 1850.

Received of David S. Lee, Seventeen 41-100 dollars, for the City,
School and Special Taxes, assessed by said City in the year 1849, on the
following property situated in said City, viz:

Part of the City.	Part of Lot.	Lot Block.	Val.	City Tax.	Sch. Tax.	Spe. Tax.	Total.
W. 25 Acres in	W. $\frac{1}{2}$ N. E. $\frac{1}{4}$	sec. 18 T. 39 N. R. 14	4.38	1.75	1.75	86.61 7.88	

JAMES FITZSIMONS,

Collector of the City of Chicago.

STATE OF ILLINOIS, }
COUNTY OF COOK, } ss.

COLLECTOR'S OFFICE, Chicago,
December 27th, 1849.

Received of David S. Lee, Fifty-three 89-100 dollars, in full for Coun-
ty, State and Special Taxes assessed for the year 1849, on the following
Real Estate, situated in said County, viz:

Division.	Sec.	Town N.	Range E.	Acres.	Valuation.	Co. Tax.	State Tax.	Spec. Tax.	Total.
<i>side</i> W. $\frac{1}{2}$ N. E. $\frac{1}{4}$	18	39	14	25	1250	5.00	6.88	.50	12.38

I. COOK, BY PENDRY, Dep'y

Sheriff and Collector of Cook Co.

STATE OF ILLINOIS, }
CITY OF CHICAGO. } ss.

COLLECTOR'S OFFICE, Chicago,
November 10th, 1849.

Received of David S. Lee for Jos. N. Balestier, Eleven 71-100 Dol-
lars, for the City, School and Special Taxes assessed by said City in the
year 1849, on the following property in said City, viz:

Part of City.	Part of Lot.	Lot.	Block.	Val.	City Tax	Sch. Tax	Spe. Tax	Total.
S. E. 5 a. in W. $\frac{1}{2}$	N. E. $\frac{1}{4}$ sec. 6	T 39 N	R. 14	1.50	1.38	.15	.15	.68
S. W. 5 a. in E. $\frac{1}{2}$	N. W. $\frac{1}{4}$ " 6	" 39 "	" 14	.50	.13	.05	.05	.23
Mid. 30 a. in W. $\frac{1}{2}$	N. E. $\frac{1}{4}$ " 18	" 39 "	" 14	24.00	6.00	2.40	2.40	10.80

\$11.71

JAMES FITZSIMONS, City Collector.

STATE OF ILLINOIS, }
COUNTY OF COOK, } ss.

COLLECTOR'S OFFICE, Chicago,
December 27th, 1849.

Received of David S. Lee for Jos. N. Balestier, Twenty-one 87-100
dollars, in full for County, State and Special Taxes assessed for the year
1849, on the following Real Estate, situate in said County, viz:

Division.	Sec.	Town N.	Range E.	Acres.	Valuation.	Co. Tax.	State Tax.	Spec. Tax.	Total.
W. $\frac{3}{4}$ N. E. $\frac{1}{4}$,	6	39	14	5	1.25	.50	.69	4	1.23
E. $\frac{1}{2}$ N. W. $\frac{1}{4}$,	6	39	14	5	.40	.16	.22	2	.40
W. $\frac{1}{2}$ N. E. $\frac{1}{4}$,	18	39	14	30	18.00	7.20	9.90	54	17.64
W. $\frac{1}{2}$ S. W. $\frac{1}{4}$,	26	39	14	80	2.40	.96	1.32	32	2.60

\$21.87

I. COOK.

Also a deed from David S. Lee to Joseph N. Balestier, dated Feb. 9,
1850, conveying a part of said tract bounded as follows: beginning at a
point on the N. side of said tract 20 rods and 4 links E. from N. W.
corner; thence S. 110 rods; thence E. 10 rods; thence N. along West
boundary line of land owned by party of the second part 110 rods;
thence W. 10 rods to beginning.

*The execution of which was
admitted*

Co & State

1850.

TAXES ASSESSED ON LANDS IN CHICAGO—WEST DIVISION.

OWNERS.	DESCRIPTION.	Section	Town-ship.	Range	Aces.	Rate per A.	Valua-tion.	State Tax.	County Tax.	Town Tax.	Total.
✓ Jos. N. Balestier, .	E. $\frac{1}{2}$ of W. $\frac{3}{4}$ of W. $\frac{1}{2}$ of N. E. $\frac{1}{4}$, -----	18	39	14	36 $\frac{1}{2}$	80	2940	17.05	11.76		28.81 Pd.
Jas. Peck and Allen Richmond,	Part of W. $\frac{3}{4}$ of W. $\frac{1}{2}$ of N. E. $\frac{1}{4}$ beginning } at S. E. corner, thence W. 4 chains, N. 12.50 } chs., E. 4 chs., and S. 12.50 chs. to beginning, }	"	"	"	5	80	400	2.32	1.60	.12	3.92
✓ David S. Lee, ----	W. $\frac{1}{2}$ of W. $\frac{3}{4}$ of W. $\frac{1}{2}$ of N. E. $\frac{1}{4}$ except 5 acres assessed to Peck and Richmond, -----	"	"	"	18 $\frac{1}{8}$	75	1359	7.88	5.43		13.31 Pd.

City

1850.

TAXES ASSESSED ON LANDS IN CHICAGO—WEST DIVISION.

OWNERS.	DESCRIPTION.	Section	Town-ship.	Range.	Aces.	Valua-tion.	City Tax.	School Tax.		
✓ David S. Lee, ----	18 $\frac{1}{8}$ acres of the W. side of W. $\frac{1}{2}$ N. E. $\frac{1}{4}$, -----	18	39	14	18 $\frac{1}{8}$	1269	3.17 $\frac{1}{2}$	1.26		Pd.
Jas. Peck, and Allen Richmond,	Part of W. $\frac{1}{2}$ of W. $\frac{3}{4}$ of W. $\frac{1}{2}$ of N. E. $\frac{1}{4}$ begin- } ning at S. E. corner, thence W. 4 chs., N. 12.50 } chs., E. 4 chs., and S. 12.50 chs. to beginning, }	"	"	"	5	400	1.00	.40		Pd.
✓ Jos. N. Balestier,	36 $\frac{1}{2}$ acres E. and adj. West 18 $\frac{1}{8}$ acres of the West side of W. $\frac{1}{2}$ of N. E. $\frac{1}{4}$, -----	"	"	"	36 $\frac{1}{2}$	2950	7.37 $\frac{1}{2}$	2.95		Pd.

Chicago, April 3d, 1851.

Received of David S. Lee for Jos. N. Balestier, Forty 44-100 Dollars, in full for County, State, Town and Special Taxes assessed for the year 1850, upon the following described lands lying in the County of Cook and State of Illinois, viz: 36 $\frac{1}{4}$ acres in W. $\frac{1}{2}$ N. E. $\frac{1}{4}$ Sec. 18 Town 39 N. R. 14, E. 3d P. M.

JAMES, LONG, Treasurer.

STATE OF ILLINOIS, }
CITY OF CHICAGO. } ss.

Dec 24
Chicago, ~~Nov. 18th~~, 1850 *44*

Received of David S. Lee for Jos. N. Balestier, ~~Twenty four 794-100~~ dollars, for City, School, ~~Interest, Lamp, Lake Shore Protection, and~~ *special* ~~Building~~ Taxes, assessed by said City for the year 1850, on the following property situated in said city, viz:

Part of City.	Sub Lot.	Lot.	Block.	Valuation.	City Tax	Sch Tax.	Int. Tax.	L.P. Tax.	Lib. St. Recr.	Dr. 44.	Total.
Mid. 36 $\frac{1}{4}$ a. in W. $\frac{1}{2}$ N. E. $\frac{1}{4}$ sec. 18 T. 39 N. R. 14.				8614	12.05	5.42	1.80			3.61	22.48
				<i>2950</i>	<i>738</i>	<i>295</i>					<i>10.33</i>

JAMES FITZSIMONS,
Collector of the City of Chicago.

STATE OF ILLINOIS, }
CITY OF CHICAGO. } ss.

COLLECTOR'S OFFICE, Chicago,
January 20th, 1851.

Received of David S. Lee, Twelve 58-100 dollars, for the City, School, and Special Taxes, assessed by said City in the year 1850, on the following property situated in said City, viz:

Part of the City.	Part of Lot.	Lot Block.	Val.	City Tax.	Sch. Tax.	Total.
W. 18 $\frac{1}{8}$ A. in W. $\frac{1}{2}$ N. E. $\frac{1}{4}$ sec. 18		T 39 NR 14	1269	3.17	1.27	\$4.44

JAMES FITZSIMONS,
Collector of the City of Chicago,
By JAMES H. REES.

STATE OF ILLINOIS, }
COUNTY OF COOK, } ss.

COLLECTOR'S OFFICE, Chicago,
April 3d, 1851.

Received of David S. Lee, Fifty-seven 44-100 dollars, in full for State, County, and Town Taxes levied for the year 1850, on the following described property:

Part of Town.	Lot.	Block.	Val.	St. Tax.	Co. Tax.	Tn Tax.	Total.
W. 18 $\frac{1}{8}$ a. in W. $\frac{1}{2}$ N. E. $\frac{1}{4}$ sec.	18 T39	NR. 14	1360	7.88	5.43	.50	13.81

JAMES LONG, Treasurer.

1851.

TAXES ASSESSED ON LANDS IN CHICAGO—WEST DIVISION.

Co & State

OWNERS.	DESCRIPTION.	Section	Town-ship.	Range	Acres.	Val. per A.	State Tax.	County Tax.	Town Tax.	Val. of Real Estate.	Total.
✓ Jos. N. Balestier,	E. $\frac{1}{2}$ of W. $\frac{3}{4}$ of W. $\frac{1}{2}$ of N. E. $\frac{1}{4}$,	18	39	14	30	90	16.29	10.80	1.35	2700	27.09 Pd. 135
Jas. Peck and Allen Richmond,	Part of W. $\frac{3}{4}$ of W. $\frac{1}{2}$ of N. E. $\frac{1}{4}$ beginning at S. E. corner, thence W. 4 chains, N. 12.50 chs., E. 4 chs., and S. 12.50 chs. to beginning, }	"	"	"	5	90	2.72	1.80	.22 $\frac{1}{2}$	450	4.52
✓ David S. Lee,....	N. $\frac{1}{2}$ of W. $\frac{3}{4}$ of W. $\frac{1}{2}$ of N. E. $\frac{1}{4}$ except 5 acres assessed to Peck and Richmond,	"	"	"	25	80	12.07	8.00	1.00	3000	20.07 Pd.

1851.

TAXES ASSESSED ON LANDS IN CHICAGO—WEST DIVISION.

City -

OWNERS.	DESCRIPTION.	Section	Town-ship.	Range	Acres.	Valua- tion.	City Tax.	School Tax.	Inter'st Tax.	Build'g Tax.	Total.
✓ David S. Lee,....	18 $\frac{1}{2}$ acres of the W. side of W. $\frac{1}{2}$ N. E. $\frac{1}{4}$,	18	39	14		1812 $\frac{1}{2}$	6.34 $\frac{1}{4}$	2.71 $\frac{3}{4}$.90 $\frac{1}{2}$	1.81 $\frac{1}{4}$	11.78 Pd.
Jas. Peck, and Allen Richmond,	Part of W. $\frac{1}{2}$ of W. $\frac{3}{4}$ of W. $\frac{1}{2}$ of N. E. $\frac{1}{4}$ beginning at S. E. corner, thence W. 4 chs., N. 12.50 chs., E. 4 chs., and S. 12.50 chs. to beginning, }	"	"	"	5	500	1.75	.75	.25	.80 $\frac{1}{2}$	3.25 Pd.
✓ Jos. N. Balestier,	36 $\frac{1}{2}$ acres E. and adj. West 18 $\frac{1}{2}$ acres of the West side of W. $\frac{1}{2}$ of N. E. $\frac{1}{4}$,	"	"	"	36 $\frac{1}{2}$	3614	12.65	5.42	1.80 $\frac{3}{4}$	3.61 $\frac{1}{2}$	23.49 $\frac{1}{4}$ Pd.

STATE OF ILLINOIS, }
COUNTY OF COOK, } ss. West Chicago, January 10th, 1852.
Town of West Chicago. }

Received of D. S. Lee, for J. N. Balestier, Forty-five dollars and four cents, in full for State, County and Town Taxes, levied for the year 1851 on the following described property :

Part of Town.	Lot.	Block.	Val.	St. Tax.	T'n Tax	Co. Tax.	Total.
36 $\frac{1}{2}$ a.(mid.) W. $\frac{1}{2}$ N.E. $\frac{1}{4}$ sec.	18 T39	NR.14		19.61	13.00	1.63	34.24

JOHN SPRY, Collector West Chicago.

STATE OF ILLINOIS, }
CITY OF CHICAGO. } ss. COLLECTOR'S OFFICE, Chicago,
November 20th, 1851.

Received of David S. Lee for Jos. N. Balestier, Twenty-four 79 $\frac{1}{4}$ -100 dollars, for City, School, Interest, Lamp, Lake Shore Protection, and Building Taxes, assessed by said City for the year 1851, on the following property situated in said city, viz :

Part of City.	Sub Lot.	Lot.	Block.	Valuation.	City Tax	Sch Tax	Int. Tax	Build.Tax.	Total.
S.E.5a. in W. $\frac{1}{2}$ N.E. $\frac{1}{4}$ s.6 T39 NR.14				1.50	52 $\frac{1}{4}$	22 $\frac{1}{2}$	7 $\frac{1}{2}$	15	97 $\frac{1}{2}$
SW5a. in E. $\frac{1}{2}$ NW. $\frac{1}{4}$ s.6 T39 NR.14				.50	17 $\frac{1}{2}$	7 $\frac{1}{2}$	2 $\frac{1}{2}$	5	32 $\frac{1}{2}$
Mid.36 $\frac{1}{2}$ in W. $\frac{1}{2}$ N.E. $\frac{1}{4}$ s.18 T30 NR14				36.14	12.65	5.42	1.80 $\frac{3}{4}$	3.61 $\frac{1}{2}$	23.49 $\frac{1}{4}$
									\$24.79 $\frac{1}{4}$

JAMES FITZSIMONS,
Collector of the City of Chicago.

STATE OF ILLINOIS, }
CITY OF CHICAGO. } ss. COLLECTOR'S OFFICE, Chicago,
Nov. 13th, 1851.

Received of David S. Lee, Sixty-four 79 $\frac{1}{4}$ -100 dollars, for City, School, Interest, Lake Shore Protection and Building Taxes, assessed by said City, for the year 1851, on the following property situated in said City, viz :

Part of City.	Sub-lot.	Lot.	Blk.	Valuation.	Cit. Tax.	Sch. Tax	Int.Tax.	L'p Tax.	L'ke Sh. Pro.Tax.	B'ld.Tax.	Total.
W. 18 $\frac{1}{2}$ a. in W. $\frac{1}{2}$ N. E. $\frac{1}{4}$ sec.18 T.				18.12 $\frac{1}{2}$	6.34 $\frac{1}{4}$	2.71 $\frac{3}{4}$.90 $\frac{1}{2}$			1.81 $\frac{1}{4}$	11.78
39 N. R. 14.											

JAMES FITZSIMONS,
Collector of the City of Chicago.

STATE OF ILLINOIS, }
COUNTY OF COOK, } ss. COLLECTOR'S OFFICE, Chicago,
Jan'y 10, 1852.

Received of David S. Lee, Fifty dollars and 80 cents, in full for State, County, and Town Taxes levied for the year 1851, on the following described property :

Part of Town.	Lot.	Block.	Valuation.	State Tax.	Co. Tax.	T'n.Tax.	Total.
W.18 $\frac{1}{2}$ a.in W. $\frac{1}{2}$ N E $\frac{1}{4}$ s	18T 39	NR.14,1450		8.75	5.80	.72	15.27

JOHN SPRY, Collector West Chicago.

1852-1853

City

1852.

TAXES ASSESSED ON LANDS IN CHICAGO—WEST DIVISION.

OWNERS.	DESCRIPTION.	Section	Town-ship.	Range.	Aces.	Valua- tion.	City Tax.	School Tax.	Inter'st Tax.	Build'g Tax.	Hydr. Tax.	Market Tax.	Divis- ion Tax.	Total.
✓ David S. Lee, ----	18½ acres of the W. side of W. ½ N. E. ¼, -----	18	39	14	18½	2712	9.49	2.71½	1.35½	2.71½	2.71½	1.35½	1.35½	21.69½ Pd.
Jas. Peck, and Allen Richmond,	Part of W. ½ of W. ¾ of W. ½ of N. E. ¼ begin- ning at S. E. corner, thence W. 4 chs., N. 12.50 chs., E. 4 chs., and S. 12.50 chs. to beginning, }	"	"	"	5	500	1.75	.50	.25	.50	.50	.25	.25	4.00 Pd.
✓ Jos. N. Balestier,	36½ acres E. and adj. West 18½ acres of the West side of W. ½ of N. E. ¼, -----	"	"	"	36½	5305	18.56½	5.30½	2.65	5.30	5.30	2.65	2.65	42.44 Pd.

Co & State

1852.

TAXES ASSESSED ON LANDS IN CHICAGO—WEST DIVISION.

OWNERS.	DESCRIPTION.	Section	Town-ship.	Range	Aces.	Val. per A.	Valua- tion.	Inter'st Tax.	State Tax.	County Tax.	Town Tax.	Total.
✓ Jos. N. Balestier, ..	E. ½ of W. ¾ of W. ½ of N. E. ¼, -----	18	39	14	30	200	6000	7.50	36.20	24.00	3.60	71.30 Pd. by D. S. Lee.
Jas. Peck and Allen Richmond,	Part of W. ¾ of W. ½ of N. E. ¼ beginning at S. E. corner, thence W. 4 chains, N. 12.50 chs., E. 4 chs., and S. 12.50 chs. to beginning, }	"	"	"	5	120	600	.75	3.62	2.40	.36	7.43 Pd. by Jas. Peck.
✓ David S. Lee, ----	W. ½ of W. ¾ of W. ½ of N. E. ¼ except 5 acres assessed to Peck and Richmond, -----	"	"	"	25	170	42.50	5.31	25.64	17.00	2.55	50.50 Pd.

STATE OF ILLINOIS, }
COOK COUNTY, } ss.

Town of West Chicago,
February 19th, 1852. ³

Received of D. S. Lee, for J. N. Balestier, ninety-four dollars and 69 cents in full of all taxes due for the year 1852, on the following described Real Estate and on personal property, as valued below, to wit:

Part of Town.	Sub Lot.	Lot.	Block.	Val.	Int. Tax.	St. Tax.	Co. Tax.	Tn. Tax.	Total Tax.
Middle 36 $\frac{1}{2}$ acres in sec. 18 T. 39 N. R. 14	W. 14	$\frac{1}{2}$ N E	$\frac{1}{4}$	71.68	8.97	43.24	28.68	4.29	85.18

JOHN O'NEILL, Collector of Town of West Chicago.

STATE OF ILLINOIS, }
CITY OF CHICAGO. } ss.

COLLECTOR'S OFFICE, Chicago,
January 10th, 1853.

Received of D. S. Lee for J. N. Balestier, the sum of forty-two dollars and forty-four cents for City, School, Interest, Building, Hydraulic, Market, and Division Taxes, assessed by said City for the year 1852, on the following property, viz:

Description.	Sec.	Tn.	Ran.	Acres.	Val.	Cl. Tax.	Sc Tax.	In. T x	B'd T x	Hy. T.	Mar. T.	Div. T.	Total.
36 $\frac{1}{2}$ a. E. & ad. W. 18 $\frac{1}{2}$ of W. 1/4 Lot W. 1/4 of NE 1/4	18	39	14	36 $\frac{1}{2}$	5303	18.56	5.30	2.65	5.30	5.30	2.65	2.65	42.44

STATE OF ILLINOIS, }
CITY OF CHICAGO. } ss.

COLLECTOR'S OFFICE, Chicago,
Jan'y 10th, 1853.

Received of David S. Lee, One hundred and twenty-seven 26-100 dollars for City, School, Interest, Building, Hydraulic, Market and Division taxes assessed by said City for the year 1852, on the following property, viz:

Part of City.	Sub Lot.	Lot.	Block.	Val.	Cl Tax.	Sc Tax.	L'p Tax.	In. T x	B'd T x	Hy. T.	Mar. T.	Div. T	Total.
West 18 $\frac{1}{2}$ acres in W. 1/2 Sec. 18 T 39 N R 14 E.	N E	$\frac{1}{4}$		27.12	9.49 $\frac{1}{4}$	2.71 $\frac{1}{4}$		1.35 $\frac{3}{4}$	2.71 $\frac{1}{4}$	1.35 $\frac{3}{4}$	1.35 $\frac{3}{4}$	1.35 $\frac{3}{4}$	21.70

JAMES FITZSIMONS, City Collector.

STATE OF ILLINOIS, }
COUNTY OF COOK, } ss.

Town of West Chicago,
Feb. 19, 1853.

Received of David S. Lee, One hundred and fifteen dollars and 61 cents, in full of all taxes due for the year 1852, on the following described Real Estate and personal property, as valued below, to wit:

Part of Town.	Sub Lot.	Lot.	Block.	Val.	Int. T.	St Tax	Co Tax	Tn T.	Sc Tax	R'd Tax.	Eq. T.	Back Tax.	Total.
West 18 $\frac{1}{2}$ acres in W. 1/2 Sec. 18 T. 39 N. R. 14 E.	N E	$\frac{1}{4}$		3081	3.84	18.60	12.32	1.86					36.62

JOHN O'NEILL,

Collector of the Town of West Chicago.

1853.

TAXES ASSESSED ON LANDS IN CHICAGO—WEST DIVISION.

City

OWNERS.	DESCRIPTION.	Section	Town-ship.	Range.	Aces.	City Tax.	Valua-tion.	Inter'st Tax.	Build'g Tax.	Total.
✓ David S. Lee, ----	18½ acres of the W. side of W. ½ N. E. ¼, -----	18	39	14	18½		7200	.61	.20	61.20 Pd.
Jas. Peck, and Allen Richmond,	Part of W. ½ of W. ¾ of W. ½ of N. E. ¼ begin- ning at S. E. corner, thence W. 4 chs., N. 12.50 chs., E. 4 chs., and S. 12.50 chs. to beginning, }	"	"	"	5		3700	.31	.45	31.45 Pd.
✓ Peacock and Thatcher,	36½ acres E. and adj. West 18½ acres of the West side of W. ½ of N. E. ¼, -----	"	"	"	36½		14400	1.22	.40	122.40 Pd.

Co & State.

1853.

TAXES ASSESSED ON LANDS IN CHICAGO—WEST DIVISION.

OWNERS.	DESCRIPTION.	Section	Town-ship.	Range	Aces.	Val. per A.	Valua-tion.	State Tax.	County Tax.	Town Tax.	School Tax.	
Jos. N. Balestier, -	E. ½ of W. ¾ of W. ½ of N. E. ¼, -----	18	39	14	36½	500	18638	90.96	73.75	5.68	15.37	Pd.
Jas. Peck and Allen Richmond,	Part of W. ¾ of W. ½ of N. E. ¼ beginning at S. E. corner, thence W. 4 chains, N. 12.50 chs., E. 4 chs., and S. 12.50 chs. to beginning, }	"	"	"	5	250	1250	6.17	5.00	.25	1.06	Pd.
✓ David S. Lee, ----	W. ½ of W. ¾ of W. ½ of N. E. ¼ except 5 acres assessed to Peck and Richmond, -----	"	"	"	18½	500	9062	44.71	36.25	1.81	7.55	Pd.

STATE OF ILLINOIS, }
COOK COUNTY, } ss.

Town of West Chicago,
February 4th, 1854.

Received of David S. Lee, Six hundred and fifty-seven dollars and eleven cents, in full of all taxes due for the year 1853, on the following described Real Estate, and on personal property as valued below, to wit:

Part of Town.	Part of Lot.	Sub-lot.	Lot.	Block.	Valuation.	St. Tax.	Int. Tax.	Co. Tax.	T'n Tax.	Total.
W. 18 $\frac{1}{8}$ a. in W. $\frac{1}{2}$ N. E. $\frac{1}{4}$ S. 18 T 39 N. R. 14 E.					90.62	44.71	7.55	36.25	1.81	90.32

PATRICK HENNESY, Collector of West Chicago.

STATE OF ILLINOIS, }
CITY OF CHICAGO. } ss.

COLLECTOR'S OFFICE, Chicago,
October 22d, 1853.

Received of David S. Lee, Three Hundred and eighty-two 78 $\frac{1}{4}$ dollars, for City Tax 3 $\frac{1}{2}$ m, School Tax 1 $\frac{1}{2}$ m, Interest Tax $\frac{1}{2}$ m, Building Tax 1 m, Water Tax 1 m, Market Tax 1 m, Lamp District Tax, $\frac{1}{2}$ m, as the taxes assessed by said City for the year 1853, on the following described property situated in said City, viz:

Part of City.	Sub Lot.	Lot.	Block.	Valuation.	General Taxes.	Lamp Tax.	Total.
W. 18 $\frac{1}{8}$ a. in W. $\frac{1}{2}$ NE $\frac{1}{4}$ S. 18 T 39 NR 14				7,200	61.20		61.20

JAMES FITZSIMONS, Collector.

STATE OF ILLINOIS, }
COOK COUNTY, } ss.

Chicago, March 28, 1854.

Received of D. S. Lee, for J. N. Balestier, Two hundred and thirteen dollars and 64 cents, in full of the following taxes, due for the year 1853, on the following described Real Estate and personal property, as valued below, to wit:

Part of Sec.	Sec.	Town.	Range	Val.	^{Sch} Int. Tax.	St. Tax.	Co. Tax.	T'n Tax.	Sch. Tax.	R'd Tax.	Total.
Un. $\frac{1}{2}$ S. W. $\frac{1}{4}$	4	38	12	480	.40	2.38	1.92	.14	.48	.64	5.96
W. $\frac{1}{2}$ of SW $\frac{1}{4}$	26	39	13	2400	2.00	11.84	9.60	.48			23.92
Mid. 36 $\frac{3}{4}$ a. in W. $\frac{1}{2}$ N. E. $\frac{1}{4}$	18	39	14	18438	18.37	90.96	73.78	6.68			183.76

\$213.64

H. C. N. HEALD, Treasurer.

STATE OF ILLINOIS, }
CITY OF CHICAGO. } ss.

COLLECTOR'S OFFICE, Chicago,
Oct. 22d, 1853.

Received of D. S. Lee for J. N. Balestier, One hundred and twenty-two 40-100 dollars, for City Taxes 3 $\frac{1}{2}$ m, School Tax 1 $\frac{1}{2}$ m, Interest Tax $\frac{1}{2}$ m, Building Tax 1 m, Water Tax 1 m, Market Tax 1 m, Lamp Tax $\frac{1}{2}$ m, as the taxes assessed by said City for the year 1853, on the following described property situated in said City, viz:

	Sub-lot.	Lot.	Block.	Valuation.	Gen'l Tax.	L/p. Tax.	Total.
Mid. 36 $\frac{3}{4}$ a. W. $\frac{1}{2}$ N E $\frac{1}{4}$ S 18 T 39 NR. 14 E				14,400	122.40		122.40

JAMES FITZSIMONS, City Collector.

STATE OF ILLINOIS, }
CITY OF CHICAGO. } ss.

COLLECTOR'S OFFICE,
Dec'r 26th, 1854.

Received of David S. Lee, Eight hundred and twelve 08-100 dollars, for City Tax $3\frac{1}{2}$ m, School Tax $1\frac{1}{2}$ m, Interest Tax 1 m, Lamp Tax 1 m, Building Tax 1 m, Market Tax $\frac{1}{2}$ m, Division Tax, $1\frac{1}{2}$ m, as the taxes assessed by said City for the year 1854, on the following described property situated in said City, viz :

Part of City.	Sub Lot.	Lot.	Block.	Valuation.	General Taxes.	Lamp Tax.	Total.
W. $18\frac{1}{8}$ a. in W. $\frac{1}{2}$ NE $\frac{1}{4}$ s. 18 T 39 NR 14				9000			81.00

JAMES FITZSIMONS, City Collector.

STATE OF ILLINOIS, }
COUNTY OF COOK, } ss.

Town of West Chicago,
January 15th, 1855.

Received of David S. Lee, Five hundred and seventy dollars and 34 cents, in full of all taxes due for the year 1854, on the following described Real Estate, and on personal property as valued below, to wit :

Part of Town.	Sub-lot.	Lot.	Block.	Valuation.	St. Tax.	Co. Tax.	T'n Tax.	Sch. Tax.	R'd Tax.	Total.
W. $18\frac{1}{8}$ a. in W. $\frac{1}{2}$ N. E. $\frac{1}{4}$ s. 18 T 39 N. R. 14 E.				44.87 90.62	44.71 44.67	30.21	3.17			78.05

A. C. ELLITHORPE, Collector of Town of West Chicago.

STATE OF ILLINOIS, }
COOK COUNTY, } ss.

Chicago, March 28, 1855.

Received of D. S. Lee, for J. N. Balestier, One hundred and eighty-five dollars and 63 cents, in full of all taxes due for the year 1854, on the following described Real Estate and on personal property, as valued below, to wit :

Part of Sec.	Sec.	Town.	Range	Acres.	Val.	St. Tax.	Co. Tax.	T'n Tax.	R'd Tax.	Total.
Un. $\frac{1}{2}$ S. W. $\frac{1}{4}$	4	38	12		480	2.37	1.60	1.22	96	6.15
W. $\frac{1}{2}$ of SW $\frac{1}{4}$	26	38	13		2400	11.83	8.00	.84		20.67
Mid. $36\frac{3}{4}$ a in W $\frac{1}{2}$ N. E. $\frac{1}{4}$	18	39	14		18438	90.90	61.46	6.45		158.81

\$185.63

H. C. N. ~~NEWELL~~ ^{Herald}, Treasurer Cook County.

STATE OF ILLINOIS, }
CITY OF CHICAGO. } ss.

WEST DIVISION COLLECTOR'S OFFICE,
Chicago, April 10th, 1855.

Received of D. S. Lee for J. N. Balestier, One hundred and eighty 10-100 dollars, for City Tax $3\frac{1}{2}$ m, School Tax $1\frac{1}{2}$ m, Interest Tax 1 m, Building Tax 1 m, Market Tax 1 m, Union Park Tax 1 m, as the taxes assessed by said City for the year 1854, on the following described property situated in said City, viz :

Part of City.	Sub-lot.	Lot.	Block.	Valuation.	General Tax.	Total.
$36\frac{3}{4}$ acres E. and adjoining of W. $\frac{1}{2}$ of N. E. $\frac{1}{4}$	W. 18 $\frac{3}{4}$ Sec. 18,	acres 39, 14	off W. side	20,000		180.00
						.10

\$180.10

JACOB RUSSELL, per H. KOESCH,
Collector.

1854.

TAXES ASSESSED ON LANDS IN CHICAGO—WEST DIVISION.

OWNERS.	DESCRIPTION.	Section	Town-ship.	Range.	Valua-tion.	Build'g Tax.	Total.	Aces.	
David S. Lee, ----	18½ acres off the W. side of W. ½ N. E. ¼, -----	18	39	14	9000	81.00	81.00	18½	Pd.
Jas. Peck, and Allen Richmond,	Part of W. ½ of W. ¾ of W. ½ of N. E. ¼ begin- ning at S. E. corner, thence W. 4 chs., N. 12.50 chs., E. 4 chs., and S. 12.50 chs. to beginning, }	"	"	"	3500	31.50	31.50	5	Pd.
Peacock and Thatcher,	36½ acres E. and adj. West 18½ acres off the West side of W. ½ of N. E. ¼, -----	"	"	"	20000	180.00	180.00	36½	Pd.

1854.

TAXES ASSESSED ON LANDS IN CHICAGO—WEST DIVISION.

OWNERS.	DESCRIPTION.	Section	Town-ship.	Range	Aces.	Valua-tion.	State Tax.	County Tax.	Town Tax.	Total.
✓ Jos. N. Balestier,	E. ½ of W. ¾ of W. ½ of N. E. ¼, -----	18	39	14	36½	18438	90.90	61.46	6.45	158.81
Jas. Peck and Allen Richmond,	Part of W. ¾ of W. ½ of N. E. ¼ beginning at S. E. corner, thence W. 4 chains, N. 12.50 chs., E. 4 chs., and S. 12.50 chs. to beginning, }	"	"	"	5	1250	6.16	4.17	.44	10.77
David S. Lee, ----	W. ½ of W. ¾ of N. E. ¼ except 5 acres assessed to Peck and Richmond, -----	"	"	"	18½	9062	106.57 44.67	30.21	3.17	78.05 Pd.

STATE OF ILLINOIS, }
COUNTY OF COOK, } ss.

Town of West Chicago,
November 20th, 1855.

Received of David S. Lee, Two hundred and seventy dollars 72-100 in full of all State, County, Town and School taxes due for the year 1855, on the following described Real Estate, and on personal property as valued below, to wit:

Part of Town.	Sub-lot.	Lot.	Block.	Valuation.	St. Tax.	Co. Tax.	T'n Tax	Sc. Tax	Total Tax.
W. 18 $\frac{1}{8}$ a. of W. $\frac{1}{2}$ N. E. $\frac{1}{4}$ S. 18 T 39 N. R. 14 E.				10800					111.24

D. H. HOWARD, Collector of Town of West Chicago.

STATE OF ILLINOIS, }
CITY OF CHICAGO. } ss.

COLLECTOR'S OFFICE, Chicago,
Nov'r 20th, 1855.

Received of David S. Lee, One hundred and eighty-five 20-100 dollars, for City Tax 3 $\frac{1}{2}$ m, Reform School Tax 1 m, Interest Tax 1 m, Building Tax $\frac{1}{2}$ m, Market Tax $\frac{1}{2}$ m, Hospital Tax 1 m, Union Park Tax $\frac{1}{2}$ m, Lamp Tax 1 m, as the taxes assessed by said City for the year 1855, on the following described property situated in said City, viz:

Part of City.	Sub Lot.	Lot.	Block.	Valuation.	Total Taxes.
W. 18 $\frac{1}{8}$ a. of W. $\frac{1}{2}$ NE $\frac{1}{4}$ S. 18 T 39 NR 14 E.				10,000	\$80.00

JACOB RUSSELL, Collector.

STATE OF ILLINOIS, }
COUNTY OF COOK, } ss.
Town of West Chicago.

Town of West Chicago,
November 20, 1855.

Received of D. S. Lee, for J. N. Balestier, One hundred and nineteen 94-100 dollars, in full of all State, County, Town and School taxes due for the year 1855, on the following described Real Estate and on personal property, as valued below, to wit:

Part of Town.	Sub Lot.	Lot.	Block.	Val.	St. Tax.	Co. Tax.	T'n Tax.	Sch. Tax.	Total Tax.
30 $\frac{3}{8}$ acres E. and adjoining W. side of W. $\frac{1}{2}$ of N. E. $\frac{1}{4}$ S. 18 T 39 NR 14 E.				11.640					\$119.94

D. H. HOWARD,

Per F. A. SMITH.

STATE OF ILLINOIS, }
CITY OF CHICAGO. } ss.

WEST DIVISION COLLECTOR'S OFFICE,
Chicago, Nov. 20th, 1855.

Received of D. S. Lee for J. N. Balestier, One hundred and seventy-seven 60-100 dollars, for City Tax 3 $\frac{1}{2}$ m, Reform School Tax 1 m, Int. Tax 1 m, Building Tax $\frac{1}{2}$ m, Market Tax $\frac{1}{2}$ m, Hospital Tax 1 m, Union Park Tax $\frac{1}{2}$ m, Lamp Tax 1 m, as the taxes assessed by said City for the year 1855, on the following described property situated in said City, viz:

Part of City.	Sub-lot.	Lot.	Block.	Valuation.	Total Taxes.
30 $\frac{3}{8}$ acres East and adjoining W. 18 $\frac{1}{8}$ acres off Sec. 18 T. 39 N. R. 14 E.	W. side	W. $\frac{1}{2}$	N. E. $\frac{1}{4}$	22,200.00	\$177.60

JACOB RUSSELL, Collector.

1855.

TAXES ASSESSED ON LANDS IN CHICAGO—WEST DIVISION.

OWNERS.	DESCRIPTION.	Section	Town-ship.	Range.	Valua- tion.	Build'g Tax.	Total.	
D. S. Lee,-----	18 $\frac{1}{8}$ acres off the W. side of W. $\frac{1}{2}$ N. E. $\frac{1}{4}$,-----	18	39	14	10000	80.00	80.00	Pd.
Jas. Peck, and Allen Richmond,	Part of W. $\frac{1}{2}$ of W. $\frac{3}{4}$ of W. $\frac{1}{2}$ of N. E. $\frac{1}{4}$ begin- ning at S. E. corner, thence W. 4 chs., N. 12.50 chs., E. 4 chs., and S. 12.50 chs. to beginning. }	"	"	"	2500	20.00	20.00	Pd.
Peacock and Thatcher,	36 $\frac{7}{8}$ acres E. and adj. West 18 $\frac{1}{8}$ acres off the West side of W. $\frac{1}{2}$ of N. E. $\frac{1}{4}$,-----	"	"	"	22200	177.60	177.60	Pd.

1855.

TAXES ASSESSED ON LANDS IN CHICAGO—WEST DIVISION.

	Valuation	State and Co. Tax.	Town Tax.	Total.	
Jas. Peck and Allen Richmond,	\$2500	\$25	.75	\$25.75 Pd. By Jas. Peck.	Part of W. $\frac{1}{2}$ of N. E. $\frac{1}{4}$ beginning 7.50 chs. E. of S. W. corner of N. E. $\frac{1}{4}$ thence W. 4 chs., N. 12.50 chs., E. 4 chs. and S. 12.50 chs. to beginning. (5 acres.)
David S. Lee,	\$10800	\$108	\$3.24	\$111.24 Pd.	Part of W. $\frac{1}{2}$ N. E. $\frac{1}{4}$, beginning 3.56 chs. E. of S. W. corner of N. E. $\frac{1}{4}$, thence N. 12.50 chs., E. 15 chs., N. 27.50, W. 5 chs., S. on W. Line of W. $\frac{1}{4}$ 40 chs.; E. 3.50 chs. to beginning. (18 $\frac{1}{8}$ acres.)

Part of W. $\frac{1}{2}$ of N. E. $\frac{1}{4}$ Sec. 18, T. 39, R. 14, beginning 15.19 chs. E. of S. W. corner of N. E. $\frac{1}{4}$, thence N. 40 chs., W. 10.10 chs., S. 27.50 chs., E. 2.50 chs., and S. 12.50 chs. E. by 69 chs. to beginning. (37.60 acres.) Sub-divided by D. S. Lee.

1855.	Lot.	Block.	Valua- tion.	State & Co. Tax	Town Tax.	Total.	
D. S. Lee,-----	1	1	85	85	3	88	Pd.
"-----	2						
"-----	3						
"-----	4						
"-----	5						
"-----	6						
"-----	7						
"-----	8						
"-----	9						
"-----	10						
"-----	11						
"-----	12						
"-----	1	3	80	80	2	82	
"-----	2						
"-----	3						
"-----	4						
"-----	5						
"-----	6						
"-----	7						
"-----	8						
"-----	9						
"-----	10						
"-----	11						
"-----	12						
"-----	13						
"-----	14						
"-----		3	950	950	29	979	
"-----		4					
"-----		5					
"-----		6					
"-----		7					
"-----		8					
"-----		9					
"-----		10					
"-----		11					
"-----		12					

The execution of which several receipts were severally admitted and that the persons executing the same were at the time of the execution thereof severally the officers which they assume to be as said several receipts. And it was also admitted that ^{said} several assessment rolls, and warrants for the collections of taxes, were the originals for the years therein named.

The Plaintiff then called Reuben Taylor as a witness, who, being sworn, testified, that in 1845, a portion of the premises in controversy were ploughed by the witness for the plaintiff, who then acted as the agent of Mr. Meletta. No part of the premises were ever enclosed. Nothing has ever been done upon the premises since the ploughing in 1845 up to the time Newkirk took possession of the premises. From 1845 to the time when Newkirk took possession, the premises were vacant and unoccupied like the rest of the open prairie. Newkirk took possession in the fall of 1855, and built a fence around the premises, and has been in possession ever since.

This was all the evidence in the case, and upon the same being introduced, the plaintiff rested his case, and thereupon the defendant, by his counsel, moved the Court to exclude the same from the jury on the ground that the same did not establish a title on the part of the said plaintiff to the premises described in his declaration, which motion was sustained and granted by the Court, and the whole of said evidence excluded from the jury. To which decision and ruling of the Court, and the exclusion of said evidence as aforesaid the Plaintiff then and there excepted, and prays the Court to sign this his Bill of Exceptions, which is accordingly done.

David S Lorr Appellant }
 " } Supreme Court
 Adamson B Newkirk Appellee } April Term 1857

It is hereby stipulated and agreed that the foregoing abstract shall be filed in the above entitled cause in lieu and place of a full transcript of the record therein, without further certificate or attestation of the same, and that the time for filing the same is extended to Monday April 27th 1857. Error may be assigned upon said abstract in the same ^{manner} as upon a full and complete transcript of the original record —

C. F. Kunth
 Atty for App
 B. J. Morris for Deft

David S Lee Appellant } Supreme Court
vs }
Adams B. McKim Appellee } April Term 1857

And now the said David S Lee
by his Attorney Le Breche, comes and says that in
the record & proceedings aforesaid there is manifest error
in this: that the court erred in excluding the evidence
offered by the said plff. and granting the motion
of the deft to exclude the same

Wherefore the error aforesaid the plff prays
that the said judgment may be reversed
or aside and be held for nothing.

C Breche

Atty for Plff

And now the said McKim by his
Atty Mann comes and says that in the
record & proceedings aforesaid there is no
error, and prays that the judgment
may be affirmed - &c.

B. Mann for Deft

David S Lrr Appellant } Supreme Court
 " }
 Adamson B McKirk Appellee } April Term 1857

It is hereby stipulated and agreed
 that the above cause shall be submitted
 on written arguments to be filed ~~by the~~
 first day of October 1857, and the cause
 to be held under advisement by the court
 until the term of the court to be held
 at Mt Vernon -

B. S. Morris for
 Appellant

126

David C. Lee

vs

Adams & New Kirk

Filed August 23. 1857

L. Leland

Clerk